

一片式内螺纹球阀

1PC Screwed Ball Valve

- ◇ 使用压力 1000PSI
- ◇ 材质: 304, 316
- ◇ Working pressure 1000PSI
- ◇ Material: 304, 316



主要参数 Parameters(mm)

size	D	L	H	W
1/4"	5	39	38	62.5
3/8"	7	44	40	73
1/2"	9.2	56.5	51	85
3/4"	12.5	59	53.5	87
1"	16	71	56	107
1-1/4"	20	78	61.5	107
1-1/2"	25	83	68	130
2"	32	100	73	130

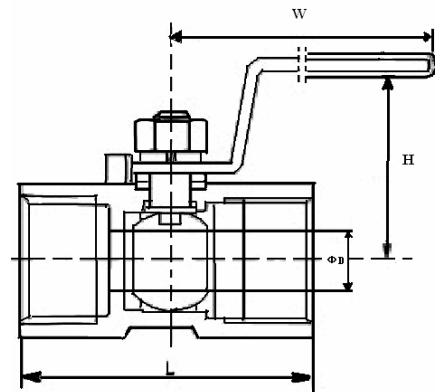

二片式内螺纹球阀

2PC Screwed Ball Valve

- ◇ 使用压力 1000PSI
- ◇ 材质: 304, 316
- ◇ Working pressure 1000PSI
- ◇ Material: 304, 316



主要参数 Parameters(mm)

size	D	L	H	W
1/4"	11.5	48.5	51.5	99
3/8"	12.5	48.5	51.5	99
1/2"	15	56	53	105
3/4"	20	65	56	105
1"	25	75	66	121
1-1/4"	32	87	74	137
1-1/2"	40	98	83	160
2"	50	125	92	190

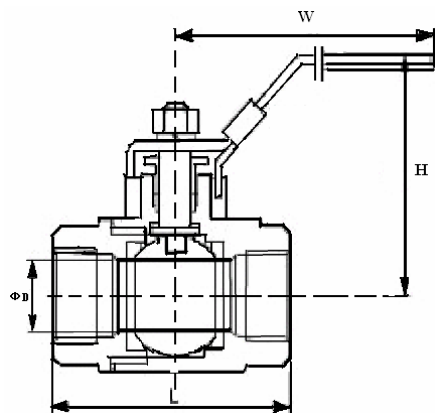

三片式内螺纹球阀

3PC Screwed Ball Valve

- ◇ 使用压力 1000PSI
- ◇ 材质: 304, 316
- ◇ 阀门可加挂锁装置
- ◇ Working pressure 1000PSI
- ◇ Material: 304, 316
- ◇ Options: Locking device



主要参数 Parameters(mm)

size	D	L	H	W
1/4"	12.5	52	40	103
3/8"	12.5	52	40	103
1/2"	15	70.5	54	125
3/4"	20	73	62.5	125
1"	25	82.5	72	160
1-1/4"	32	101	81.5	160
1-1/2"	40	112.5	91.6	190
2"	50	134.5	99.5	190
2-1/2"	65	173	125	283
3"	80	192	136	283

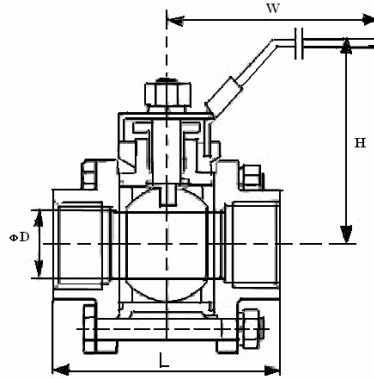

三片式对焊球阀

3PC Butt Weld End Ball Valve

- ◇ 使用压力 1000PSI
- ◇ 材质: 304, 316
- ◇ 阀门可加挂锁装置
- ◇ 对焊端设计标准 ANSI B16.25/GB1224
- ◇ Working pressure 1000PSI
- ◇ Material: 304, 316
- ◇ Options: Locking device
- ◇ Butt weld end ANSI B16.25/GB1224



主要参数 Parameters(mm)

size	d	D	L	H	W
1/4"	11.6	14	65	47.8	120
3/8"	12.7	17.5	65	47.8	120
1/2"	15	22.7	65	54	120
3/4"	20	27.5	75	57.4	130
1"	25	34	85	72	154
1-1/4"	32	42	100	79	154
1-1/2"	38	49	125	81	185
2"	50.8	60.5	150	97	185
2-1/2"	65	76.5	170	150	280
3"	80	91	185	160	280

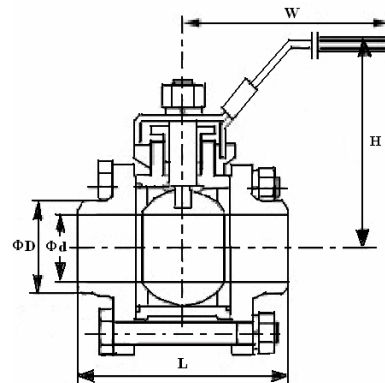

三片式承插焊球阀

3PC Socket Weld End Ball Valve

- ◇ 使用压力 1000PSI
- ◇ 材质: 304, 316
- ◇ 阀门可加挂锁装置
- ◇ 承插端设计标准 ANSI B16.11
- ◇ Working pressure 1000PSI
- ◇ Material: 304, 316
- ◇ Options: Locking device
- ◇ Pipe thread ANSI B16.11



主要参数 Parameters(mm)

size	d	L	H	D	C	W
1/4"	11.6	65	48	14.10-14.35	9.5	120
3/8"	12.7	65	48	17.55-17.80	9.5	120
1/2"	15	67	54	21.70-21.95	9.5	120
3/4"	20	82	57	27.05-27.30	11.1	130
1"	25	91	72	33.80-34.05	12.7	154
1-1/4"	32	108	79	42.55-42.80	14.3	154
1-1/2"	38	129	81	48.65-48.90	15.9	185
2"	50.8	148	97	61.10-61.35	17.4	185
2-1/2"	65	174	150	76.7-77.10	19	280
3"	80	206	160	90.15-89.80	19	280
4"	100	226	180	115.8-115.45	19	320

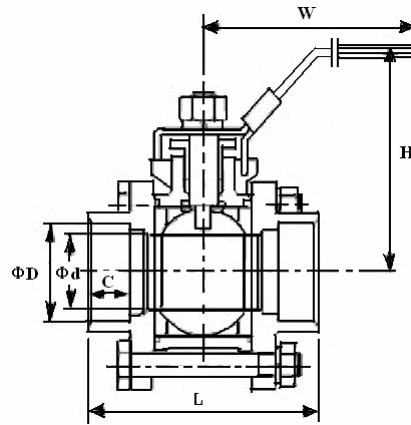

三片式卡箍球阀

3PC Clamp End Ball Valve

- ◇ 使用压力 1000PSI
- ◇ 材质: 304, 316
- ◇ 阀门可加挂锁装置
- ◇ 阀门可在管道中进行快速连接
- ◇ Working pressure 1000PSI
- ◇ Material: 304, 316
- ◇ Options: Locking device
- ◇ Valves can be installed on the pipes quickly

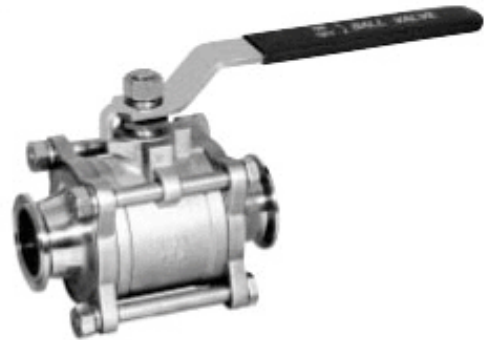

主要参数 Parameters(mm)

size	d	D	L	S	H	T1	T2	W
1/2"	9.6	25.0	75	20.24	54	-	3.63	125
3/4"	15.9	25.0	90	20.24	57.4	-	3.63	125
1"	22.2	50.4	100	43.60	72	2.85	4.75	140
1-1/4"	28.5	50.4	110	43.60	79	2.85	4.75	140
1-1/2"	34.9	50.4	125	43.60	81	2.85	-	200
2"	47.5	63.9	150	56.30	97	2.85	-	

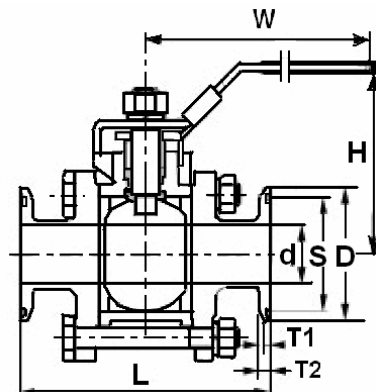

三片式球阀 (带阀架座)

3PC Screwed Ball Valve (With Mounting Flanged)

- ◇ 使用压力: 1000PSI
- ◇ 材质: 304, 316
- ◇ 阀体设置 ISO5211 标准阀架座, 可配置相应气动、电动装置
- ◇ Working pressure: 1000PSI
- ◇ Material: 304, 316
- ◇ The valve body is equipped with ISO5211 standard valve seat.



主要参数 Parameters(mm)

size	D	L	H	W
1/2"	15	70	66	165
3/4"	20	84	74	165
1"	25	92	87	200
1-1/4"	32	109	92	200
1-1/2"	38	126	105	250
2"	50	145	115	250

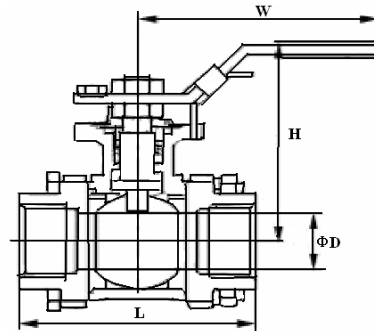

三片式活接对焊球阀

3PC Union Butt Weld Ball Valve

- ◇ 使用压力: 1000PSI
- ◇ 材质(Material): 304, 316
- ◇ 对焊端设计标准(Butt weld end)ANSI B16.25/GB1224
- ◇ 活接特殊结构避免焊接过程对阀座的影响
- ◇ Working pressure: 1000PSI
- ◇ Material: 304, 316
- ◇ In the welding process, the impact on valve seat can be avoided by the special design.



主要参数 Parameters(mm)

size	d	D	L	H	W
1/4"	11.6	17	150	48	120
3/8"	12.7	17	150	48	120
1/2"	15	21	180	54	120
3/4"	20	26	195	57	130
1"	25	31	210	72	154
1-1/4"	32	38	225	79	154
1-1/2"	38	46	260	81	185
2"	50.8	60	300	97	185

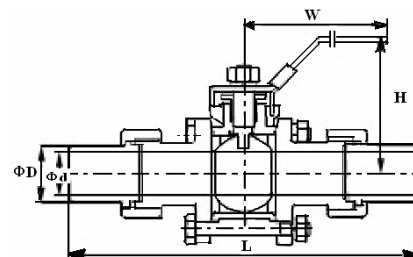

内螺纹“L” / “T”型三通球阀

3-Way Screwed L/T Port Ball Valve

- ◇ 使用压力(Working pressure) : 800PSI
- ◇ 材质(Material): 304, 316

主要参数 Parameters(mm)

size	D	A	B	C	H
1/2"	12.7	37.5	75	116	68
3/4"	16	42.5	85	116	73
1"	20	50	100	152	83
1-1/4"	25	57.5	115	152	89
1-1/2"	32	62	124	187	97
2"	38	63.5	127	187	106

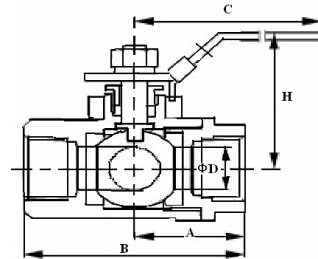

二片式法兰球阀

2PC Flanged End Full Port Ball Valve

- ◇ 使用标准 GB 标准、JIS 标准、ANSI 标准、DIN 标准
- ◇ 材质 304, 316
- ◇ 结构长度标准 GB12221、ANSI B 16.10、DIN3202
- ◇ 法兰连接标准 GB9113.3、GB9113.4、GB9113.6、GB9113.7
JIS B2212、B2213、ANSI B16.5、DIN2543、2545
- ◇ 阀体设置 ISO5211 标准阀架座，可配置相应气动、电动装置
- ◇ Standards GB、JIS、ANSI、DIN
- ◇ Material 304, 316
- ◇ Face to face GB12221、ANSI B 16.10、DIN3202
- ◇ Flange size GB9113.3、GB9113.4、GB9113.6、GB9113.7
JIS B2212、B2213、ANSI B16.5、DIN2543、2545
- ◇ The valve body is equipped with ISO5211 standard valve seat related pneumatic and electric unit can be installed.

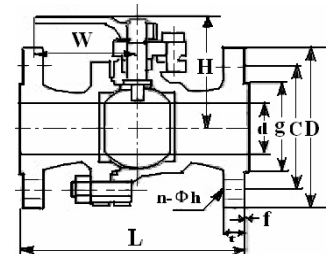

主要参数 Parameters(mm)

size	D	w	H	1.6Mpa							2.0Mpa							
				L	ΦC	Φg	n	Φh	f	t	L	ΦD	ΦC	Φg	n	Φh	f	t
1/2"	15	130	78	108	65	46	4	14	2	14	108	89	60.5	35	4	14	2	11
3/4"	20	130	88	117	75	56	4	14	2	14	117	98	70	43	4	14	2	11.5
1"	25	160	95	127	85	65	4	14	2	14	127	110	79.5	50.8	4	16	2	11.5
1-1/4"	32	225	95	140	100	76	4	18	3	16	140	120	89	63.5	4	16	2	13
1-1/2"	40	225	105	165	110	84	4	18	3	16	165	130	98.5	73	4	16	2	14.5
2"	50	250	120	178	125	99	4	18	3	16	178	150	125	92.1	4	20	2	13
2-1/2"	65	320	145	190	145	118	4	18	3	18	190	180	139.5	104.8	4	20	2	17.5
3"	80	400	150	203	160	132	8	18	3	20	203	190	152.5	127	4	20	2	19.5
4"	100	650	180	229	180	156	8	18	3	20	229	230	190.5	157.2	8	20	2	24
5"	125	650	260	356	210	184	8	18	3	22	356	255	216	185.7	8	22	2	24
6"	150	650	280	394	240	211	8	22	3	24	394	280	241.5	215.9	8	22	2	25.5
8"	200	800	350	457	295	266	12	22	3	24	457	345	398.5	269.9	8	22	2	29

不锈钢薄型球阀

Stainless Steel Thin Type Flanged Ball Valve

- ◇ 使用压力 (Working pressure): 2.0Mpa
- ◇ 材质 (Material): 304, 316, WCB

主要参数 Parameters(mm)

size	A	L	D	K	F	B	H	W	N-d
1/2"	15	35	95	65	46	10	65	110	4-M12
3/4"	20	37	105	75	56	11	70	110	4-M12
1"	25	42	115	85	65	12	80	125	4-M12
1-1/4"	32	53	135	100	76	14	90	150	4-M16
1-1/2"	40	62	160	110	85	16	96	160	4-M16
2"	50	78	180	125	100	17	104	180	4-M16
2-1/2"	65	90	185	145	118	18	110	200	4-M16
3"	80	110	200	160	132	18	130	250	8-M16
4"	100	135	215	180	156	19	145	270	8-M16

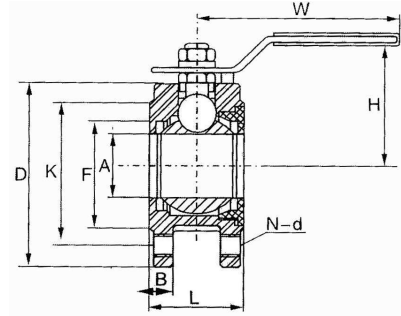

三片式法兰球阀

3PC Flanged Ball Valve

- ◇ 使用压力 4.0Mpa、5.0Mpa
- ◇ 材质 304, 316
- ◇ 法兰连接标准 ANSI B16.1 300 磅级
- ◇ 结构长度标准 ANSI B16.5
- ◇ Working pressure 4.0Mpa、5.0Mpa
- ◇ Material 304, 316
- ◇ Flange size ANSI B16.1 300
- ◇ Face to face ANSI B 16.5

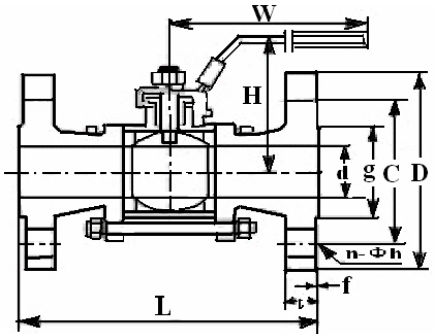

主要参数 Parameters(mm)

size	d	w	H	L	4.0Mpa							5.0Mpa						
					ΦD	ΦC	Φg	n	Φh	f	t	ΦD	ΦC	Φg	n	Φh	f	t
1/2"	15	120	54	140	95	65	46	4	14	2	14	95	66.5	35	4	16	2	14.5
3/4"	20	130	57	152	105	75	56	4	14	2	16	117	82.5	43	4	20	2	16
1"	25	154	72	165	115	85	65	4	14	3	16	125	89	50.8	4	20	2	17.5
1-1/4"	32	154	79	178	140	100	76	4	18	3	18	135	98.5	63.5	4	20	2	19.5
1-1/2"	38	185	88	190	150	110	84	4	18	3	18	155	114.5	73	4	22	2	21
2"	51	185	97	216	165	125	99	4	18	3	20	165	127	92.1	8	20	2	22.5
2-1/2"	65	280	150	241	185	145	118	8	18	3	22	190	149	104.8	8	22	2	25.5
3"	80	280	160	283	200	160	132	8	18	3	24	210	168.5	127	8	22	2	25.5
4"	100	320	180	305	235	190	156	8	22	3	24	255	200	157.2	8	22	2	32

电 / 气动球阀
Electric / Pneumatic
Ball Valve



规格 Type	15	20	25	32	40	50	65	80	100	125	150	200
电源范围 voltage of power supply	单相 single phase AC 110V/220V 50/60Hz											
动作范围 range of action	0-90											
动作时间 time of action	15 秒 (50Hz)		30 秒 (50Hz)		45 秒 (50Hz)							
驱动马达 drive motor	15W		20W		30W		90W					
保护装置 protection unit	过热保护器 (自动恢复型) Overheat protector(auto reset type)											
环境温度 ambient temperature	-25—55° C											
手动操作 Manual Operation	可卸式手柄操作 Movable handle operation											
限位元件 position limiting elements	<ul style="list-style-type: none"> ◆ 电动操作时: 全开闭极限开关 ◆ 手动操作时: 机械挡块 Full open/full close limit switch for electric drive, Mmechanical block for manual operation											
配线接口 Wiring interface	PF1/2 × 2 塑料防水接头 Plastic and water-proof connection											

1、概述

电/气动球阀由三件式球阀配置气动执行器组成，气动执行器分为双作用型和单作用型，通过电磁阀控制，实现球阀开关动作，该产品广泛地应用于石油、化工、食品、水电、冶金、供排水及水处理系统中，有较好的耐腐蚀性。

2、使用注意事项

1. 安装时阀杆应垂直地面。
2. 气动执行器需要的气源动力介质必须经过严格的除尘和除水，保证气源清洁、干燥。
3. 球阀的开关位置，不通电（双作用型需要气源正常）为关闭状态。
4. 在设备检修前，应先关闭气源和电源，再进行维修和养护。

1、Brief

The pneumatic ball valve consists of a three-piece type ball valve and an actuator.

The actuator can be double action or single action type, based on which a ball valve can be driven via solenoid.

The product, highly corrosion-resistant, has been widely used in petroleum, chemical, food, hydro-power, metallurgical industries as well as water supply and drainage and water treatment.

2、Precautions:

1. The valve stem should be vertical to the ground when being installed.
2. The air to use for the actuators should be water and dust free and clean and dry.
3. Opening/closing Positions of the ball valve: When no electricity is applied (double action needs designed air source)), the position keeps in close.
4. Air and electricity supply should be cut off before the repair and maintenance